

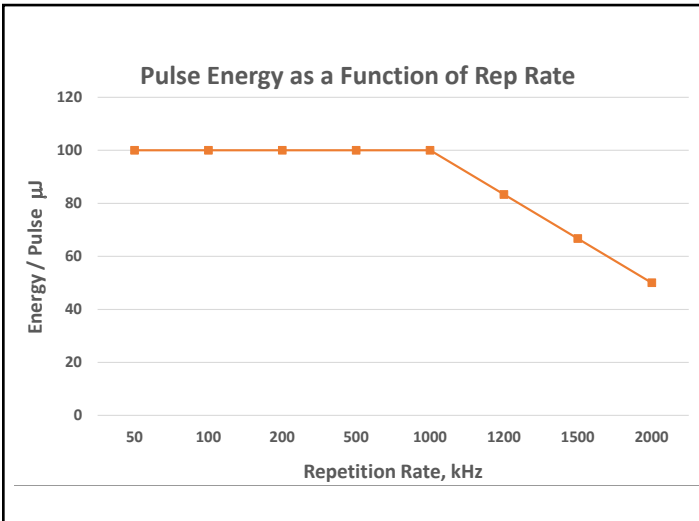

YLPF-100-900-100-R

High Pulse Energy Femtosecond Fiber Laser

NEW PRODUCT



Applications

- ▶ Medical Device Manufacturing
- ▶ Microdrilling
- ▶ Fine Tube Cutting
- ▶ Thin-film Ablation
- ▶ Silicon Dicing
- ▶ Solar Cell Structuring
- ▶ Photomask Machining
- ▶ Glass Cutting

Features

- ▶ Wavelength 1030 nm
- ▶ Pulse Energy up to 100 μ J
- ▶ High Peak Power 110 MW
- ▶ Output Power >100 W
- ▶ Pulse Duration 700-900 fs
- ▶ Repetition Rate up to 2 MHz
- ▶ Low-maintenance
- ▶ Rugged Design

IPG Photonics' NEW YLPF Series femtosecond fiber lasers provide high peak power with scalable average output power of 100 W, short pulse duration <900 fs at full operational repetition rate range of 50-2000 kHz. The fiber format allows for the adjustment of peak power and/or pulse repetition rate without affecting any of the output beam parameters. IPG's novel fiber laser is much more efficient and compact than conventional lasers now on the market. It is ideal for applications in precision micromachining.

The excellent beam quality, ultrashort pulse duration and high pulse energy combine to provide peak power densities suitable for micromachining virtually any material: metal, glass, ceramic, silicon, plastics. The ultrashort pulse duration results in a very small heat affected zone. Higher output powers are planned.

YLPF-100-900-100-R

High Pulse Energy Femtosecond Fiber Laser

Optical Characteristics

Wavelength, nm	1030
Average Power, W	100
Pulse Energy, μJ	100
Pulse Duration, fs	<900
Peak Power, MW	up to 110
Repetition Rate, kHz	50-2000
Beam Quality, M^2	<1.5 (1.3 Typ.)

General Characteristics

Control Unit Dimensions (W x D x H), mm	448 x 431 x 177
Optical Head Dimensions (W x D x H), mm	117 x 242 x 101
Cooling	Water-cooled
Supply Voltage, VAC	100-240, 50/60 Hz
Power Consumption, W	750

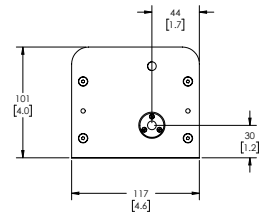
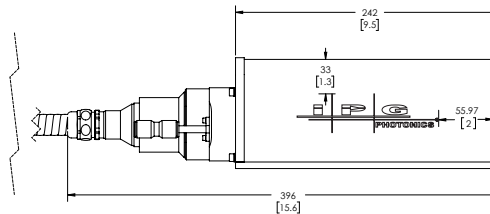
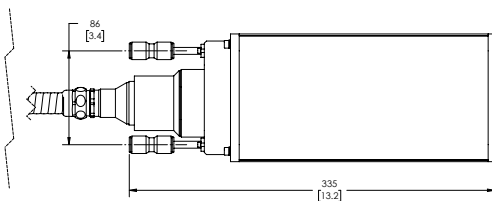

+1 (508) 373-1100
 sales.us@ipgphotonics.com
www.ipgphotonics.com

Legal notices: All product information is believed to be accurate and is subject to change without notice. Information contained herein shall legally bind IPG only if it is specifically incorporated into the terms and conditions of a sales agreement. Some specific combinations of options may not be available. The user assumes all risks and liability whatsoever in connection with use of a product or its application. IPG, IPG Photonics, The Power to Transform and IPG Photonics' logo are trademarks of IPG Photonics Corporation. © 2014-18 IPG Photonics Corporation. All rights reserved.

MAX. CONTINUOUS OUTPUT POWER: 200 W
 PEAK OUTPUT POWER: 200 MW
 PULSE DURATION: <900 fs
 PULSE REPETITION RATE: 50-2000 kHz
 WAVELENGTH RANGE: 900-1200 nm

**ANGER - INVISIBLE LASER
 RADIATION AVOID EYE OR SKIN
 EXPOSURE TO DIRECT OR
 SCATTERED RADIATION
 CLASS 4 LASER PRODUCT**

IEC 60825-1:2014

The Power to Transform®